

lime  
+ -0.820 (approx)

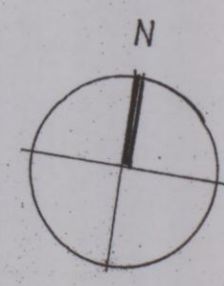

Broxtowe Borough Council  
Planning & Community Development  
12 SEP 2014

04/00560/FUL

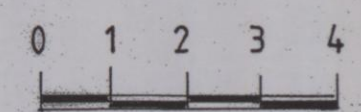
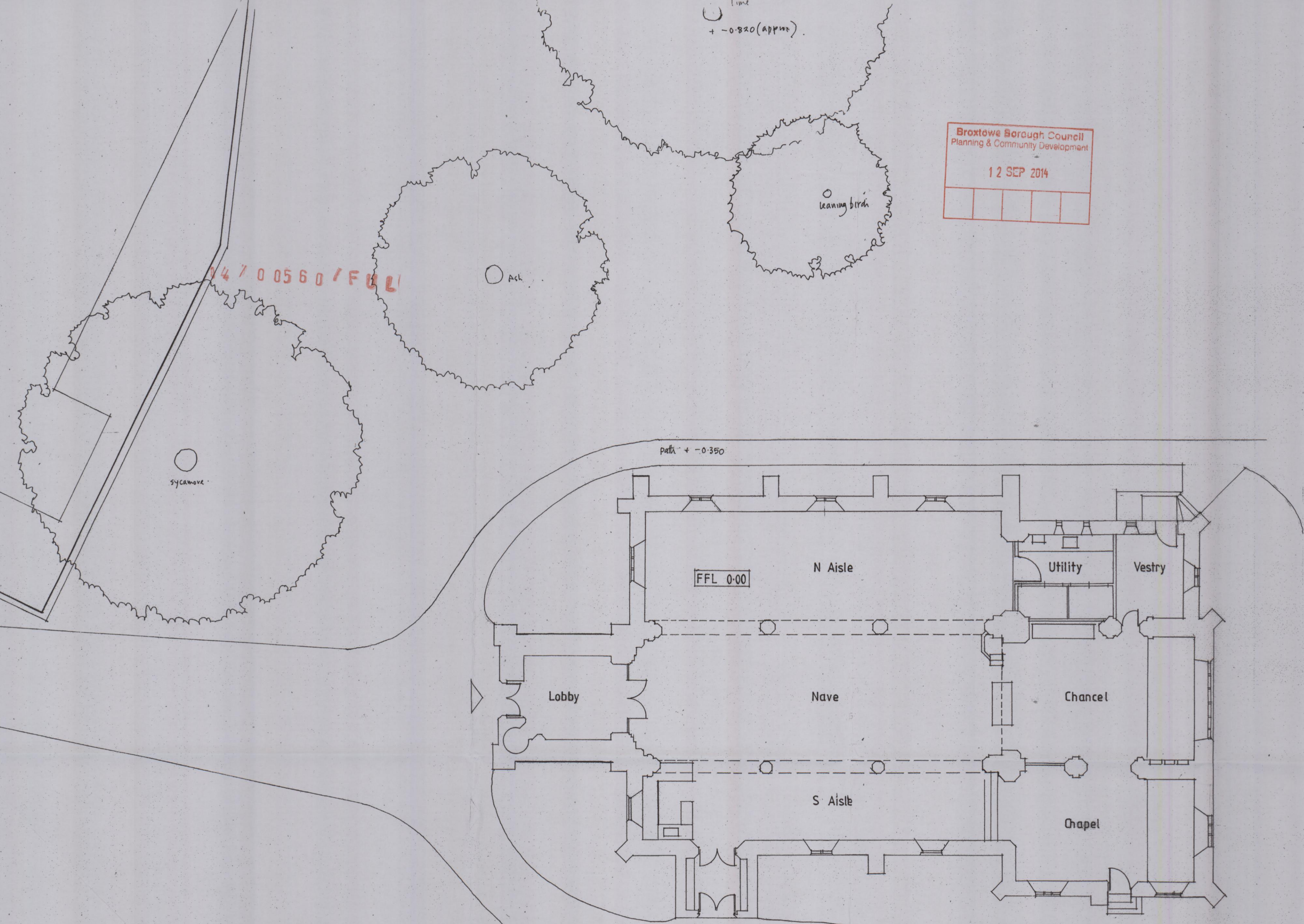

**Proposed North Side Extension for a community room & toilets  
at St Helens Church, Stapleford**

**EXISTING GROUND FLOOR PLAN**

Scale: 1:100 Date: June 2014 Drawn By: BB  
Pearl Bradley Architects: 12 Regent St, Nottingham NG1 5BQ, Tel: 0115 9473634, e:office@pearlbradley.co.uk

Drawing **E 01**