

Do not scale this drawing.
 Architects to be notified of any discrepancies.
 Contractors must check all dimensions on site.
 This drawing is copyright and is for the use on this project only.
 This drawing is to be used solely for the information as filed. For other information refer to the latest revision of any cross referenced drawings.

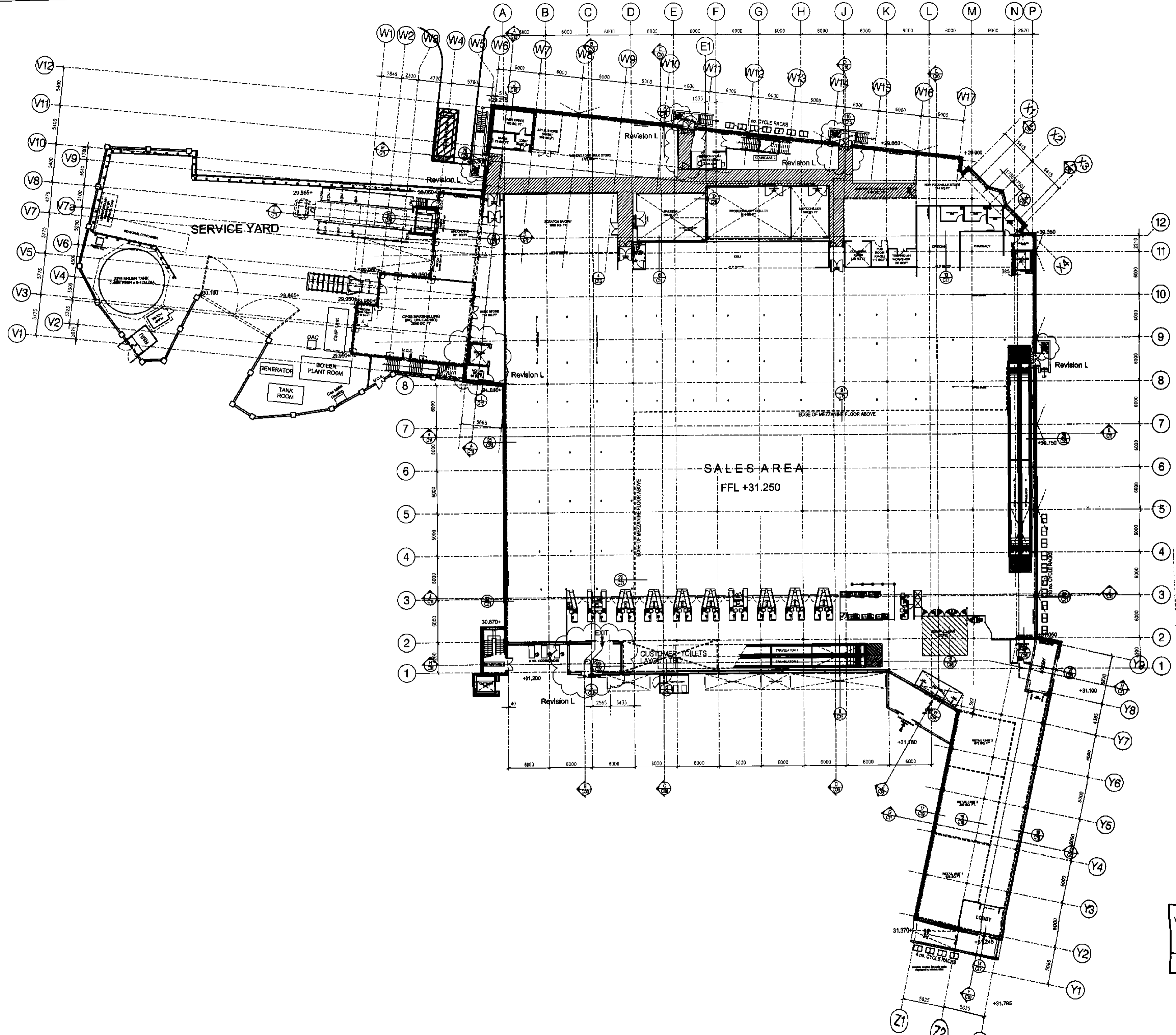

Broxtowe Borough Council
 Planning & Community Development
 26 MAY 2005

Rev	Date	Description	Auth	Chk
L	18.06.05	Plan updated to suit Phase 1 HDG Approved Retail Layout (Rev 02) - - Change 1 cycle racks (indicated by dashed lines) - Change 1 cycle racks (indicated by dashed lines) - Change 1 cycle racks (indicated by dashed lines) - Change 1 cycle racks (indicated by dashed lines)	PH	MD
K	27.04.05	Plan updated to suit Phase 1 HDG Approved Retail Layout (Rev 01) - - Change 1 cycle racks (indicated by dashed lines) - Change 1 cycle racks (indicated by dashed lines) - Change 1 cycle racks (indicated by dashed lines) - Change 1 cycle racks (indicated by dashed lines)	PH	MD
J	20.03.05	Plan updated to suit Phase 1 HDG Approved Retail Layout (Rev 00) - - Change 1 cycle racks (indicated by dashed lines) - Change 1 cycle racks (indicated by dashed lines) - Change 1 cycle racks (indicated by dashed lines) - Change 1 cycle racks (indicated by dashed lines)	PH	MD
I	01.03.05	Decision between grid lines 1 & 2 amended to 4000. Decision between grid lines 1 & 2 amended to 4000.	PH	MD
H	28.02.05	Decision between grid lines 1 & 2 amended to 4000. Decision between grid lines 1 & 2 amended to 4000.	PH	MD
G	18.02.05	Change of grid lines 1 & 2 amended to 4000. Change of grid lines 1 & 2 amended to 4000.	PH	MD
F	18.02.05	Change of grid lines 1 & 2 amended to 4000. Change of grid lines 1 & 2 amended to 4000.	PH	MD
E	09.02.05	Plan updated to suit Phase 1 HDG Approved Retail Layout (Rev 00) - - Change 1 cycle racks (indicated by dashed lines) - Change 1 cycle racks (indicated by dashed lines) - Change 1 cycle racks (indicated by dashed lines) - Change 1 cycle racks (indicated by dashed lines)	PH	MD
D	23.01.05	Plan updated to suit Phase 1 HDG Approved Retail Layout (Rev 00) - - Change 1 cycle racks (indicated by dashed lines) - Change 1 cycle racks (indicated by dashed lines) - Change 1 cycle racks (indicated by dashed lines) - Change 1 cycle racks (indicated by dashed lines)	PH	MD
C	22.01.05	STORE LAYOUT & SITE AMENDED TO FORMAT PH (REV WITH MEZZANINE)		
B	14.02.05	Final plan submitted. Dimensions profiled.		
A	09.02.05	Approved following Design Team meeting.		



Client:
Santon TESCO

Project:
TESCO STORE STATION ROAD BEESTON

TBC:
GROUND FLOOR BUILDING PLAN

Project No: 3653 / C01
 Draw No: rev L
 Date: NOV 2005

SMITH SMAILEY ARCHITECTS
 CRAVEN LODGE
 VICTORIA AVENUE
 HARROGATE
 HG1 5PX
 TEL: +44 (0)1423 631 100

Web: www.smithsmalley.co
 Email: admin@smithsmalley.co.uk

BEESTON

3C